

Shaffer® Type CVX-W Shear Rams

SHEAR AND SEAL ON MULTIPLE STRINGS CONTAINING WIRELINE

The CVX-W Shear Rams have been specifically designed to shear and seal on multiple string configurations. Typically, the multiple string configuration contains drill pipe with two or three coiled tubing strings and wireline inside. (Refer to the photo below of an actual sheared sample).

Extensive verification testing was performed on 6 $\frac{5}{8}$ " S-135 drillpipe and larger diameter shear subs. Testing involved multiple shears with sealing achieved after each shear. CVX-W Shear Rams are currently available for 18" NXT® and SLX BOPs. For additional information, please contact your NOV sales representative.

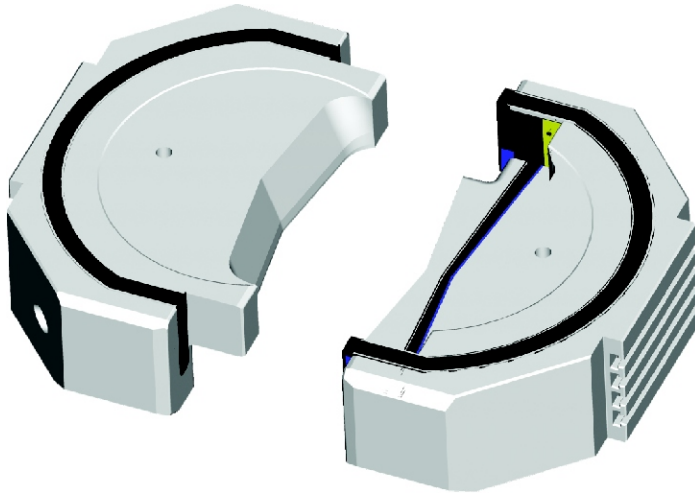

CVX-W Shear Rams

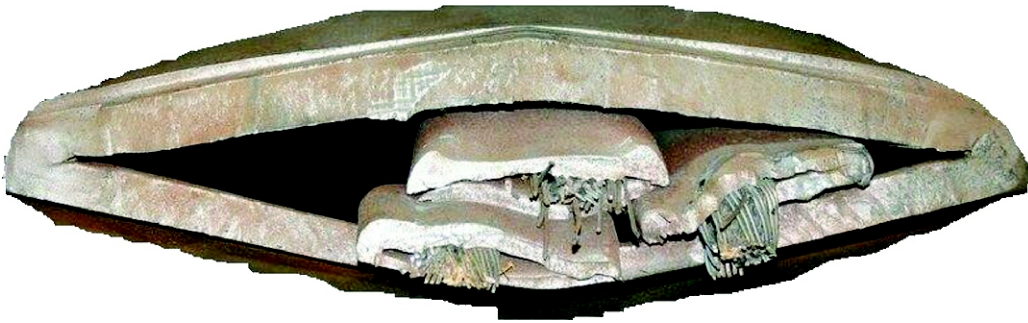

Actual Sheared Sample

Shaffer® Type CVX-W Shear Rams

CVX-W Shear Rams - Available Sizes

Size	Working Pressure	Model	Ram Assembly
18 $\frac{3}{4}$	5 / 10 / 15M	NXT	20026257
18 $\frac{3}{4}$	5 / 15M	SLX	20026256
18 $\frac{3}{4}$	10M	SLX	20026255

www.nov.com / corporatemarketing@nov.com

10000 Richmond Avenue
Houston, Texas 77042
United States
Phone: 713 346 7500
Fax: 713 435 2195

NOV NATIONAL OILWELL VARCO

© 2006 National Oilwell Varco
D391000493-MKT-001 Rev. 01